



**STRASSER**

**Manufactured *in the USA***

Every Strasser Woodenworks product is proudly made in the USA, supporting local craftsmanship and reducing the environmental footprint associated with overseas production.

**Made-to-Order Vanities**

Each vanity is custom-made to order, allowing you to select designs, finishes, and features that perfectly match your preferences and design.

**Crafted with *Quality Materials***

We only uses premium-quality materials, ensuring our products stand the test of time while maintaining their beauty and functionality.

Alki Essence .....	4	Ravenna View .....	22
Alki Spa .....	6	SoDo .....	24
Alki View .....	8	SoDo Town .....	26
Belltown .....	10	Wallingford .....	28
Montlake .....	12	Wallingford View .....	30
Montlake Town .....	14	Countertops .....	32
Montlake View .....	16	Finish Options .....	33
Newhalem .....	18	Door Styles .....	34
Ravenna .....	20	Hardware .....	35



# Alki Essence



[01.]



[02.]



[03.]

[01.] 42" Alki Essence in Silver Oak #50-613 | Brushed Nickel Contemporary Pulls #85-513 | Quartz Top in Haida #64.173

[02.] 30" Alki Essence in Smoky Cherry #19-790 | Matte Black Long Contemporary Pulls #85-532 | Quartz Top in Lattice #68.802

[03.] 60" Alki Essence in Lapis Night #58-057 | Champagne Long Contemporary Pulls #85-514 | Quartz Top in Marble Falls #64.231

## Finish Options

View all on pages 33 & 34

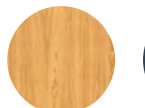

All Strasser  
Wood Options



All Strasser  
Paint Options

## Available Configurations - 18" or 21" Deep



24"

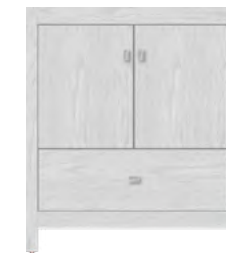

30" No Side Drawers



30" Left Drawers



30" Right Drawers



36" No Side Drawers



36" Left Drawers



36" Right Drawers



42"



48"



60" Center Basin



60" Double Basin



72" Double Basin

View page 32 for Countertops and page 35 for Hardware

no. 5

# Alki Spa



[01.]



[02.]



[03.]

[01.] 48" Alki Spa in Midnight Oak #59-693 | Satin Nickel Short Bar Pulls #85-504 | Quartz Top in Serene #64.199

[02.] 36" Alki Spa in NW Green #38-471 | Matte Black Contemporary Pulls #85-531 | Quartz top in Lattice #68.797

[03.] 30" Alki Spa in Rift White Oak #48-009 | Champagne Long Contemporary Pulls #85-514 | Integrated Top #66.310

## Finish Options

View all on pages 33 & 34



All Strasser  
Wood Options

All Strasser  
Paint Options

Rift White Oak &  
Walnut (Slab Only)

## Available Configurations - 18" or 21" Deep

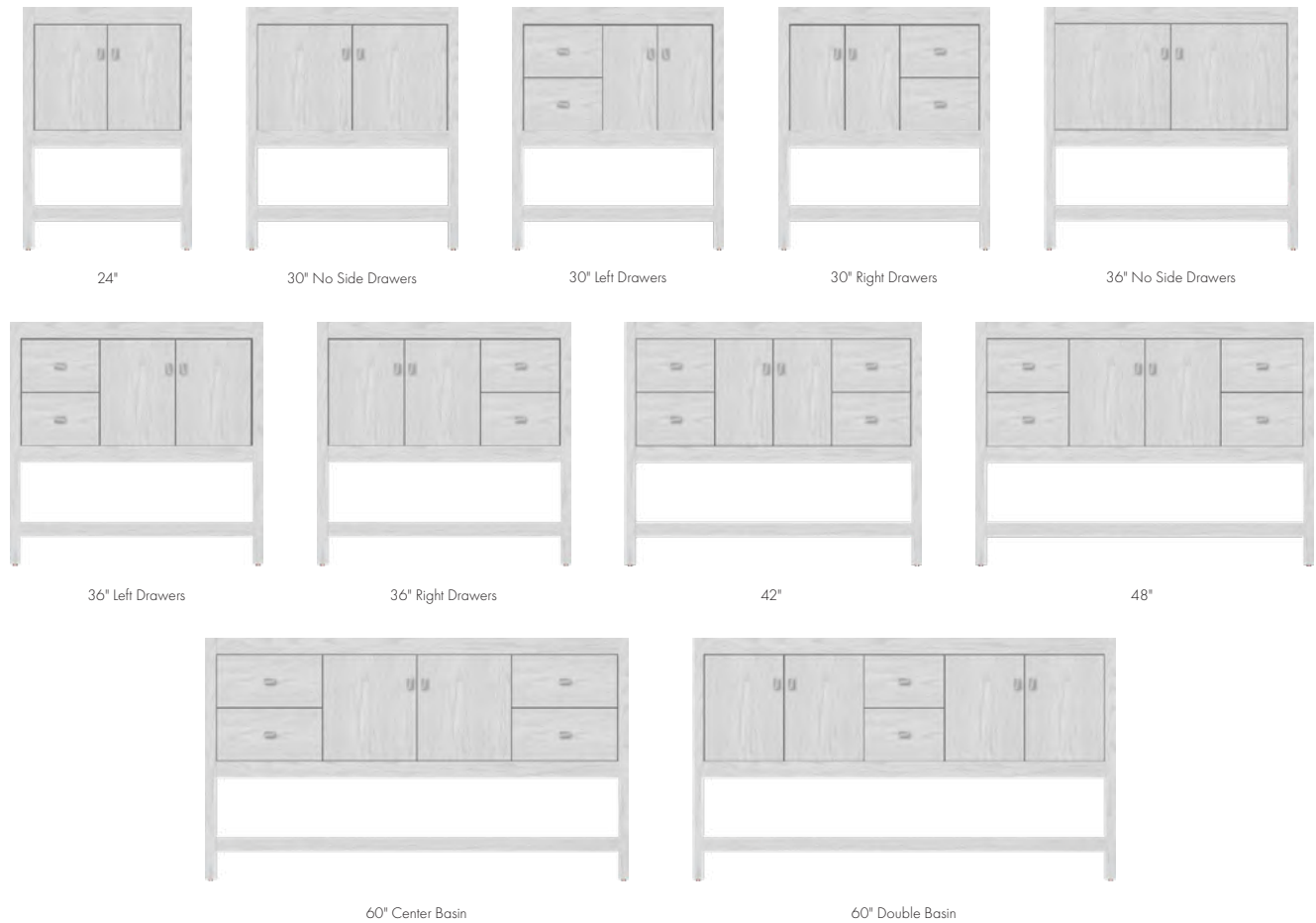

# Alki View



[01.]



[02.]



[03.]

[01.] 60" Alki View in Natural Cherry #52-582 | Brushed Nickel Long Contemporary Satin Pulls #85-515 | Quartz Top in Arctic White #64.033

[02.] 36" Alki View in Satin Black #54-131 | Polished Chrome Pulls #85-400 | Quartz Top in Grey Lake #68.841

[03.] 30" Alki View in Natural Walnut #49-031 | Champagne Arched Handles #85-524 | Quartz Top in Cotton White #68.227

## Finish Options

View all on pages 33 & 34

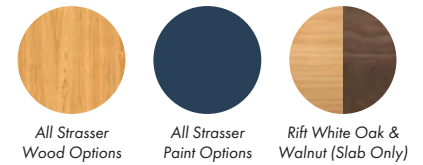

## Available Configurations - 18" or 21" Deep



# Belltown



[01.]



[02.]



[03.]

[01.] 48" Belltown in NW Green #38-790 | Champagne Long Contemporary Pulls #85-514 | Quartz Top in Marble Falls #64.195

[02.] 36" Belltown in Rift White Oak #48-055 | Champagne Contemporary Pulls #85-512 | Quartz Top in Arctic White #64.096

[03.] 24" Belltown in Pecan Cherry #55-829 | Champagne Contemporary Pulls #85-514 | Quartz Top in Haida #64.113

## Finish Options

View all on pages 33 & 34



All Strasser  
Wood Options

All Strasser  
Paint Options

Rift White Oak &  
Walnut (Slab Only)

## Available Configurations - 18" or 21" Deep



24"

30"

36"



42"



48"

# Montlake



[01.]



[02.]



[03.]

[01.] 36" Montlake Vanity in Powder Grey #27-676 & 24" Montlake Drawer Banks in Powder Grey #27-669 | Chrome Contemporary Pulls #85-529

[02.] 30" Montlake Vanity in Satin Black #15-120 & 18" Montlake Drawer Banks in Satin Black #15-131 | Chrome Contemporary Pulls #85-529

[03.] 30" Montlake in Cinnamon Cherry #23-611 | Matte Black Contemporary Pulls #85-531 | Integrated Top #66.310

## Finish Options

View all on pages 33 & 34

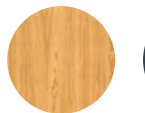

All Strasser  
Wood Options



All Strasser  
Paint Options

## Available Configurations - 18" or 21" Deep



18"



24"



24" Left Drawers



24" Right Drawers



30" No Side Drawers



30" Left Drawers



30" Right Drawers



36" No Side Drawers



36" Left Drawers



36" Right Drawers



42"



48"



60" Center Basin



60" Double Basin



72" Double Basin

# Montlake Town



[01.]



[02.]



[03.]

[01.] 42" Montlake Town in Natural Cherry #23-784 | Oiled Bronze Knobs #85-203 | Quartz Top in Serene #64.179

[02.] 48" Montlake Town in Dusky Oak #24-048 | Matte Black Large Square Knobs #85-533 | Quartz Top in Arktos #64.191

[03.] 24" Montlake Town in Satin White #22-508 | Chrome Contemporary Pulls #85-529 | Quartz Top in Arktos #64.111

## Finish Options

View all on pages 33 & 34



All Strasser  
Wood Options

All Strasser  
Paint Options

## Available Configurations - 18" or 21" Deep



24"



30"



36"



42"



48"

# Montlake View



[01.]



[02.]



[03.]

[01.] 60" Montlake View Vanities in Chocolate Cherry #11-096 & Knee Drawer in Chocolate Cherry #11-005 | Chrome Contemporary Pulls #85-529

[02.] 48" Montlake View in Satin White #29-302 | Champagne Contemporary Pulls #85-512 | Integrated Top #66.490

[03.] 36" Montlake View in Smoky Cherry #39-913 | Oiled Bronze Knobs #85-203 | Integrated Top #66.370

### Finish Options

View all on pages 33 & 34

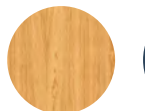

All Strasser  
Wood Options



All Strasser  
Paint Options

### Available Configurations - 18" or 21" Deep



24"



30" No Side Drawers



30" Left Drawers



30" Right Drawers



36" No Side Drawers



36" Left Drawers



36" Right Drawers



42"



48"



60" Center Basin



60" Double Basin



72" Double Basin

# Newhalem



[01.] 36" Newhalem in Natural Oak #56-230 | Matte Black Arched Handles #85-525 | Quartz Top in Arctic White #64.096

[02.] 48" Newhalem in Natural Walnut #49-080 | Matte Black Contemporary Pulls #85-531 | Quartz Top in Marble Falls #64.195

[03.] 60" Newhalem in Lapis Night #58-287 | Champagne Long Contemporary Pulls #85-514 | Quartz Top in London Grey #68.129

## Finish Options

View all on pages 33 & 34



## Available Configurations - 18" or 21" Deep

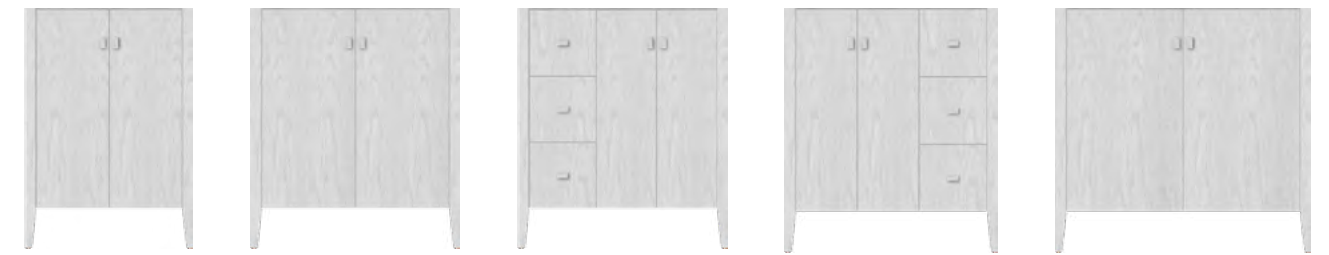

24" Hidden Drawer      30" No Side Drawers      30" Left Drawers      30" Right Drawers      36" Hidden Drawer

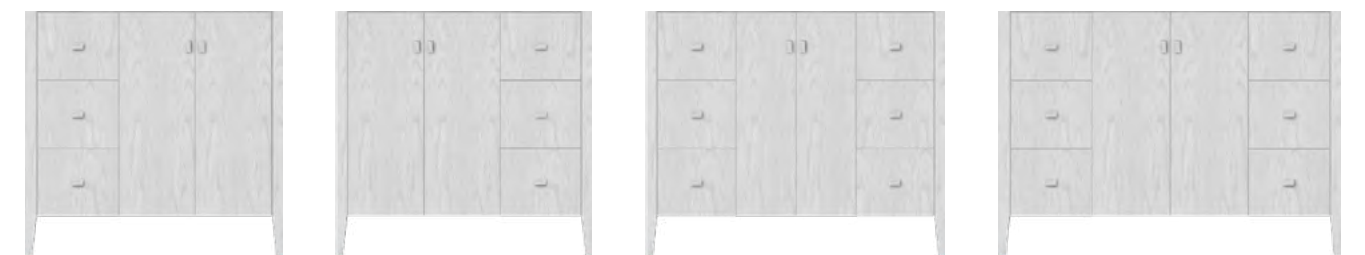

36" Left Drawers      36" Right Drawers      42"      48"

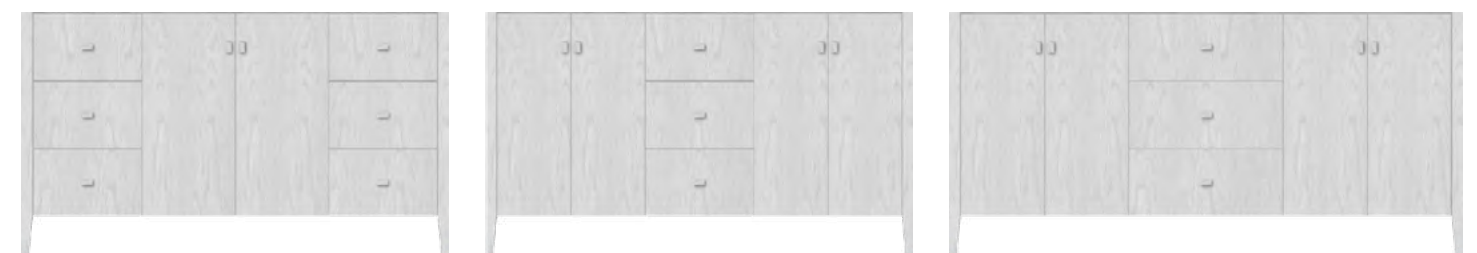

60" Center Basin      60" Double Basin      72" Double Basin

# Ravenna



[01.]



[02.]



[03.]

[01.] 60" Ravenna in Powder Grey #42-777 | Matte Black Long Contemporary Pulls #85-532 | Quartz Top in Haida #64.226

[02.] 30" Ravenna in Natural Maple #43-913 | Champagne Arched Handles #85-524 | Quartz Top in Pearl White #68.803

[03.] 30" Ravenna in Cinnamon Cherry #44-810 | Oiled Bronze Knobs #85-203 | Quartz Top in London Grey #68.139

## Finish Options

View all on pages 33 & 34

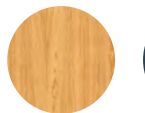

All Strasser  
Wood Options



All Strasser  
Paint Options

## Available Configurations - 18" or 21" Deep



24"



30" No Side Drawers



30" Left Drawers



30" Right Drawers



36" No Side Drawers



36" Left Drawers



36" Right Drawers



42"



48"



60" Center Basin



60" Double Basin



72" Double Basin

# Ravenna View



[01.]



[02.]



[03.]

[01.] 30" Ravenna View in Cinnamon Slate (Special Color Program) #40-764SCP | Champagne Contemporary Pulls #85-512 | Quartz Top in Via Augusta #68.884

[02.] 48" Ravenna View in Smoky Cherry #19-666 | Polished Nickel Arched Handles #85-521 | Quartz Top in Lattice #68.789

[03.] 24" Ravenna View in Satin White #40-165 | Polished Chrome Knobs #85-200 | Quartz Top in Via Augusta #68.885

## Finish Options

View all on pages 33 & 34

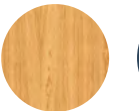

All Strasser  
Wood Options



All Strasser  
Paint Options

## Available Configurations - 18" or 21" Deep



24"



30" No Side Drawers



30" Left Drawers



30" Right Drawers



36" No Side Drawers



36" Left Drawers



36" Right Drawers



42"



48"



60" Center Basin



60" Double Basin



72" Double Basin



[01.]



[02.]



[03.]

[01.] 60" SoDo in Natural Walnut #49-113 | Matte Black Long Contemporary Pulls #85-532 | Quartz Top in London Grey #68.129

[02.] 30" SoDo in Natural Maple #20-194 | Champagne Contemporary Pulls #85-512 | Quartz Top in Arctic White #64.095

[03.] 42" SoDo in Satin White #20-137 | Champagne Contemporary Pulls #85-512 | Quartz Top in London Grey #68.135

### Finish Options

View all on pages 33 & 34



All Strasser  
Wood Options

All Strasser  
Paint Options

Rift White Oak &  
Walnut (Slab Only)

### Available Configurations - 18" or 21" Deep



24"

30" No Side Drawers

30" Left Drawers

30" Right Drawers

36" No Side Drawers



36" Left Drawers

36" Right Drawers

42"

48"



60" Center Basin



60" Double Basin

# SoDo Town



[01.]



[02.]



[03.]

[01.] 36" SoDo Town in Satin Black #25-027 | Chrome Long Contemporary Pulls #85-530 | Quartz Top in Arctic White #64.096

[02.] 24" SoDo Town in Natural Walnut #49-116 | Matte Black Long Contemporary Pulls #85-532 | Integrated Top #66.250

[03.] 30" SoDo Town in Rift White Oak #48-118 | Matte Black Long Contemporary Pulls #85-532 | Quartz Top in Lattice #68.802

## Finish Options

View all on pages 33 & 34



All Strasser  
Wood Options

All Strasser  
Paint Options

Rift White Oak &  
Walnut (Slab Only)

## Available Configurations - 18" or 21" Deep



24"



30"



36"

# Wallingford



[01.]



[02.]

[03.]

[01.] 60" Wallingford in Satin Black #38-011 | Champagne Long Contemporary Pulls #85-514 | Quartz Top in Marble Falls #64.230

[02.] 30" Wallingford in Pecan Cherry #37-843 | Oiled Bronze Knobs #85-203 | Quartz Top in Arctic White #64.095

[03.] 30" Wallingford in Natural Oak #33-526 | Matte Black Contemporary Pulls #85-531 | Integrated Top #66.310

## Finish Options

View all on pages 33 & 34



All Strasser  
Wood Options

All Strasser  
Paint Options

## Available Configurations - 18" or 21" Deep



24"



30" No Side Drawers



30" Left Drawers



30" Right Drawers



36" No Side Drawers



36" Left Drawers



36" Right Drawers



42"



48"



60" Center Basin



60" Double Basin



72" Double Basin

# Wallingford View



[01.]



[02.]



[03.]

## Finish Options

View all on pages 33 & 34



All Strasser  
Wood Options

All Strasser  
Paint Options

[01.] 60" Wallingford View in Paris Rain (Special Color Program) #38-113SCP | Champagne Long Contemporary Pulls #85-514 | Quartz Top in London Grey #68.131

[02.] 42" Wallingford View in Lapis Night #34-343 | Chrome Contemporary Pulls #85-529 | Quartz Top in Pearl White #68.794

[03.] 36" Wallingford View in Dusky Oak #30-438 | Matte Black Arched Handles #85-525 | Quartz Top in Lattice #68.797

## Available Configurations - 18" or 21" Deep



24"



30" No Side Drawers



30" Left Drawers



30" Right Drawers



36" No Side Drawers



36" Left Drawers



36" Right Drawers



42"



48"



60" Center Basin



60" Double Basin



72" Double Basin

# Countertops



## Quartz Tops

- All countertops in our quartz collection are made to fit our 19" or 22" deep vanities with a 1/2" overhang.
- All tops include a ceramic undermount sink installed with the choice of an oval or rectangular basin.
- Quartz tops can be drilled to accommodate a single hole faucet or 8" spread.

### 3cm Quartz



### 2cm Quartz



## Integrated Countertops

- Our integrated tops provide an affordable, small space option for vanities.
- Available in our 4 most popular vanity sizes, 25", 31", 37" or 49", these 22" deep tops are crisp white and easy to clean.
- Tops are predrilled to accommodate a single hole faucet or 8" spread.

# Finish Options

## Paint Colors



## Wood Stain Colors



# Door Styles

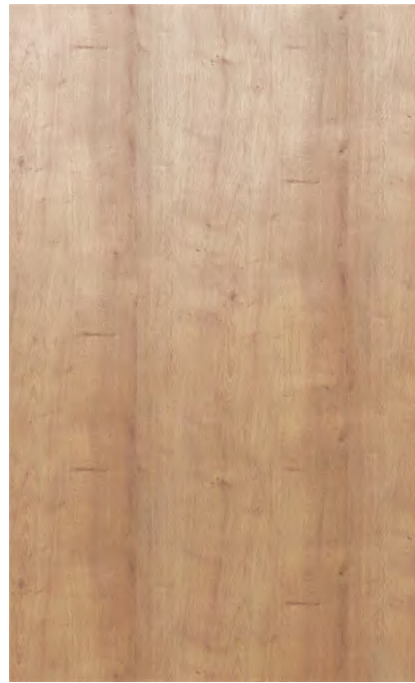

Slab



Shaker



Tiered Miter



Deco Miter



Ogee Miter



Ultraline

# Hardware

## Knobs



Polished Chrome - 85-200



Satin Nickel - 85-202



Oiled Bronze - 85-203



Matte Black - 85-533

## Pulls



Polished Chrome - 85-400



Satin Nickel - 85-402



Oiled Bronze - 85-403

## Arched Handles



Polished Nickel - 85-521



Brushed Nickel - 85-522



Oiled Bronze - 85-523



Matte Black - 85-525



Champagne - 85-524

## Contemporary Pulls



Chrome - 85-529



Brushed Nickel - 85-513



Matte Black - 85-531



Champagne - 85-512

## Long Contemporary Pulls



Chrome - 85-530



Brushed Nickel - 85-515



Matte Black - 85-531



Champagne - 85-514

## Short Bar Pulls



Polished Chrome - 85-503



Satin Nickel - 85-504



Oiled Bronze - 85-505



Matte Black - 85-520

## Medium Bar Pulls



Polished Chrome - 85-509



Satin Nickel - 85-510



Oiled Bronze - 85-511

## Long Bar Pulls



Polished Chrome - 85-506



Satin Nickel - 85-507



Oiled Bronze - 85-508

## No Hardware/No Drill

85-000

*April 2025*



[www.strasserwood.com](http://www.strasserwood.com)  
14237 NE 200th St, Woodinville,  
WA 98072  
800-445-0494  
[service@strasserwood.com](mailto:service@strasserwood.com)